



**BLUEPRINTS & CO.**  
P R O P E R T I E S

**Sales - Lettings - Management - Mortgages**



## Loxham Road

, London, E4 8SE

**£695,000**



Blueprints & Co Properties are pleased to present a fantastic opportunity to purchase this well-proportioned four-bedroom family home, situated in a quiet and desirable residential area of Chingford. Ideally positioned just moments from the A406 (North Circular), the property offers excellent transport links to Central London and beyond.

This bright and spacious home features four good-sized bedrooms, an upstairs family bathroom, a generously sized living area, and a separate kitchen/dining space. A private garage provides secure parking or valuable storage space.

Located close to local schools, parks, and amenities, this property is perfect for families or buyers looking for a well-connected yet peaceful setting. Early viewings are highly recommended.



Area Map



Floor Plans

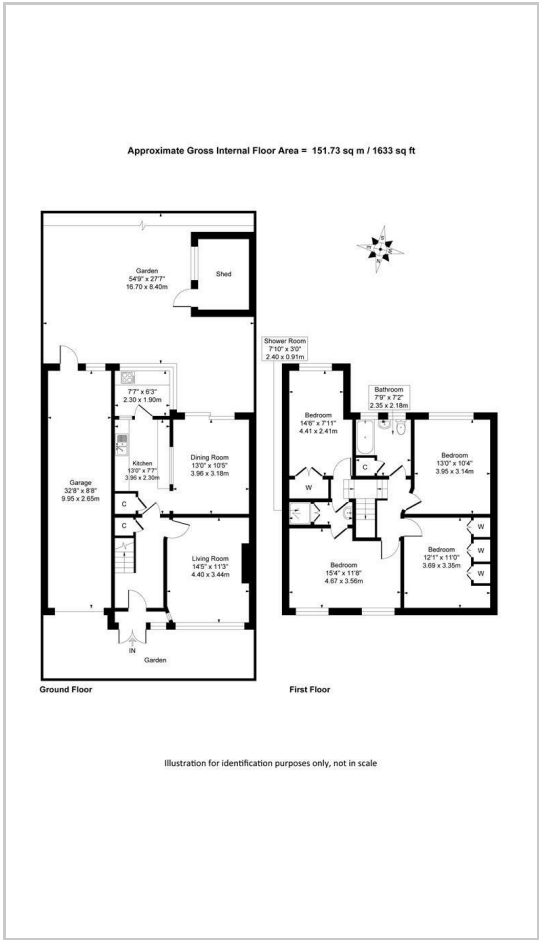

Energy Efficiency Graph

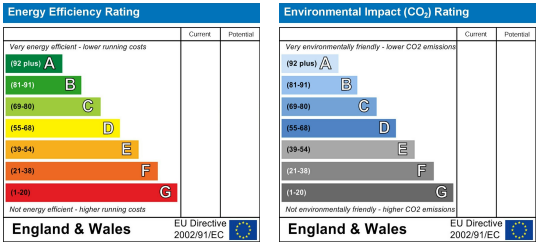

These particulars, whilst believed to be accurate are set out as a general outline only for guidance and do not constitute any part of an offer or contract. Intending purchasers should not rely on them as statements of representation of fact, but must satisfy themselves by inspection or otherwise as to their accuracy. No person in this firms employment has the authority to make or give any representation or warranty in respect of the property.