



**BLUEPRINTS & CO.**  
P R O P E R T I E S

Sales - Lettings - Management - Mortgages



## Cavendish Road

, London, N18 2LT

**Offers over £400,000**



Blueprints & Co. Properties are pleased to offer this Three-Bedroom terraced Family Home. The property is within walking distance to Silver Street and Meridian Water Stations, A406 Access, North Middlesex Hospital, and local schools all close by. The immediate area known as Angel Edmonton is renowned for its sheer variety of shops, coffee shops, and restaurants along Fore Street all within walking distance

The first floor comprises of three bedrooms and a family bathroom. The property also benefits from a 50 feet garden which makes it ideal for a family to purchase.

Viewings are highly advised



## Area Map

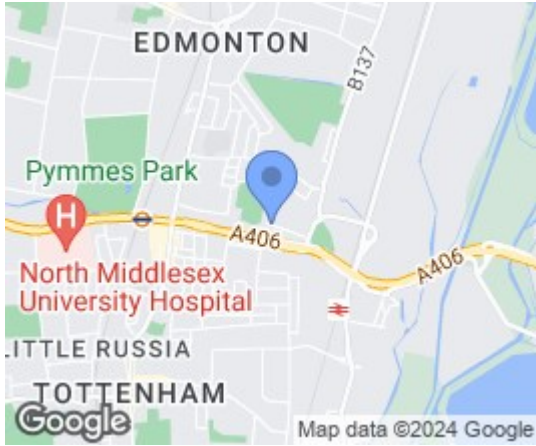

## Floor Plans

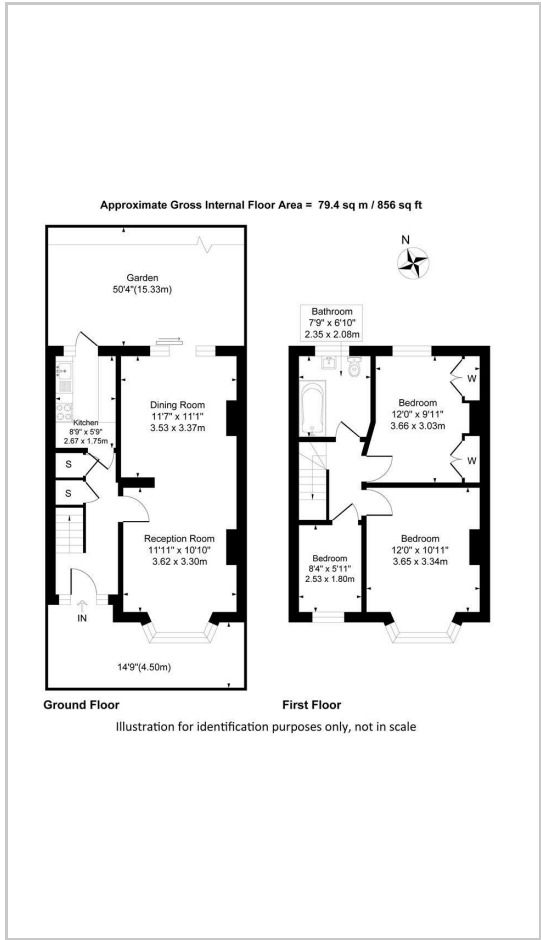

## Energy Efficiency Graph

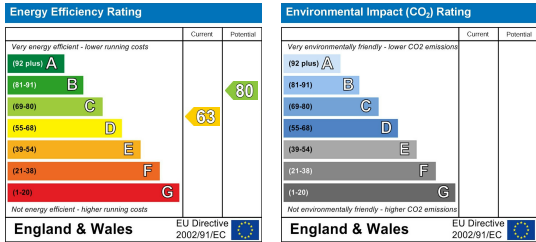

These particulars, whilst believed to be accurate are set out as a general outline only for guidance and do not constitute any part of an offer or contract. Intending purchasers should not rely on them as statements of representation of fact, but must satisfy themselves by inspection or otherwise as to their accuracy. No person in this firm's employment has the authority to make or give any representation or warranty in respect of the property.