



BLUEPRINTS & CO.
P R O P E R T I E S

Sales - Lettings - Management - Mortgages



Craig Park Road

, London, N18 2HQ

Offers in excess of £300,000



Share of Freehold!

We are delighted to present this charming two bedroom first floor converted flat. The flat features two car off street parking with separate access and a garden at the rear. The flat comprises of two double rooms along with a separate kitchen and a three piece bathroom. Located in the heart of Edmonton, this property provides easy transport links to inner London being within walking distance to Silver Street Station and Edmonton Green.

Viewings are highly advised!



Area Map

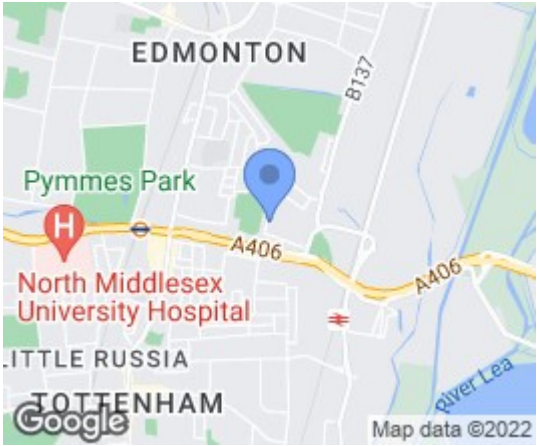

Floor Plans

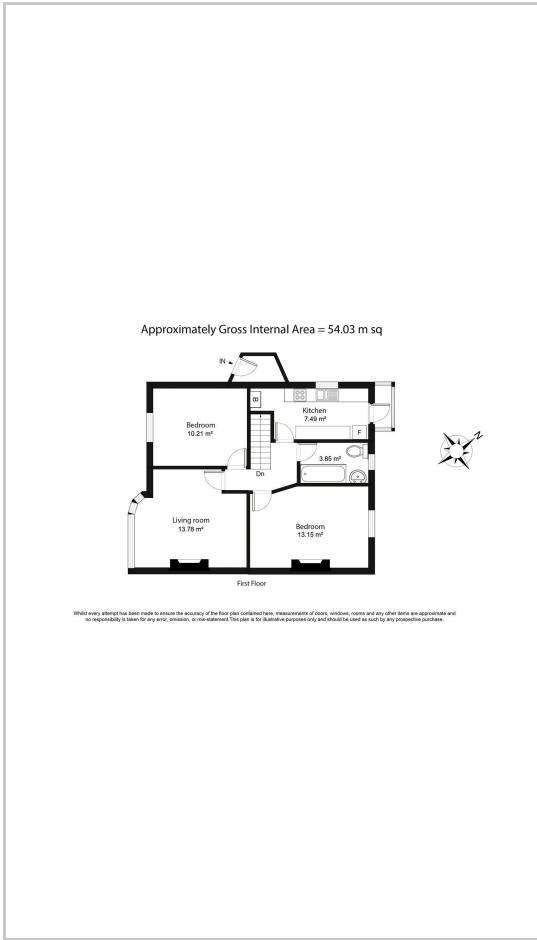

Energy Efficiency Graph



These particulars, whilst believed to be accurate are set out as a general outline only for guidance and do not constitute any part of an offer or contract. Intending purchasers should not rely on them as statements of representation of fact, but must satisfy themselves by inspection or otherwise as to their accuracy. No person in this firm's employment has the authority to make or give any representation or warranty in respect of the property.