



St. Peter's Avenue

, London, N18 2PX

Offers over £370,000



Blueprints & Co properties are pleased to offer this splendid two-bedroom nestled on the St Peters Avenue. This charming home is an ideal purchase for first-time buyers. Well cared for by the present owner this home and its garden are thoughtfully presented making it an ideal purchase.

This 1930's style family home comprises a bright and airy reception room. Further features include double glazing, gas central heating.

Located within walking distance to Edmonton Green shopping area, and Silver Street train station serves Seven Sisters tube station and Liverpool Street station.



Area Map



Floor Plans

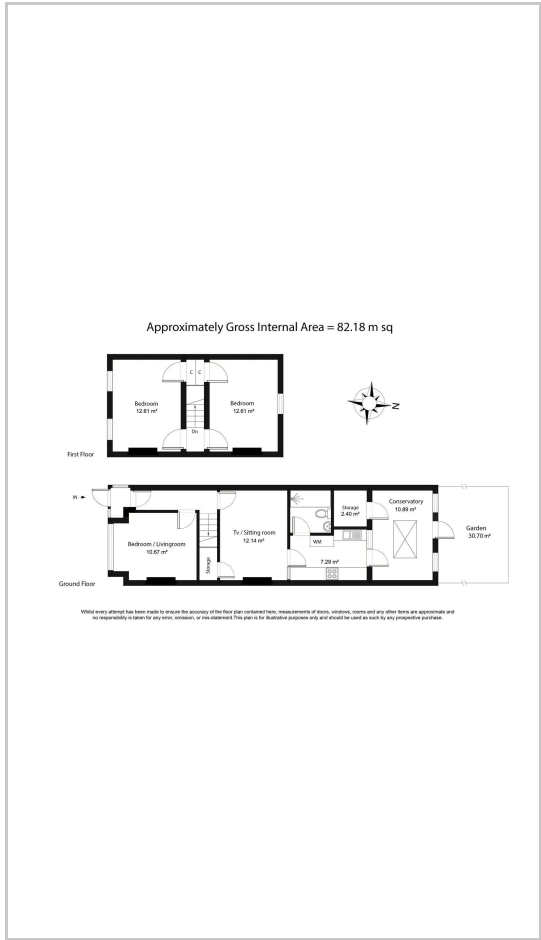

Energy Efficiency Graph

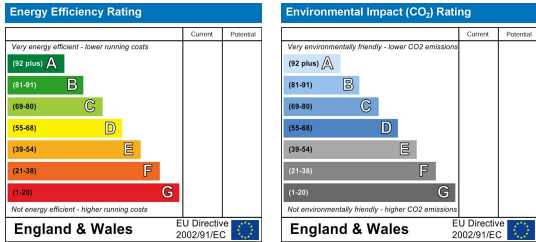

These particulars, whilst believed to be accurate are set out as a general outline only for guidance and do not constitute any part of an offer or contract. Intending purchasers should not rely on them as statements of representation of fact, but must satisfy themselves by inspection or otherwise as to their accuracy. No person in this firm's employment has the authority to make or give any representation or warranty in respect of the property.