



BLUEPRINTS & CO.
P R O P E R T I E S

Sales - Lettings - Management - Mortgages



Hertford Road

, Enfield, EN3 6UD

Offers over £250,000



Blueprints & Co. Properties are pleased to present this ground floor 2 bedroom flat set in a purpose built block, well located less than a mile to Turkey Street & Enfield Lock Stations as well as walking distance to shops & amenities.

The property is offered chain free so is ideal for first time buyers, young families or buy to let investors. Internal accommodation comprises; spacious entrance hallway, large and spacious reception room, well equipped separate kitchen, two well appointed double bedrooms and a bathroom separate to the WC. The property benefits from a large communal rear garden with allocated sheds for storage space.

Hertford Road is conveniently situated within easy reach of many shops and amenities nearby such as; Enfield's Retail Park, Sainsburys supermarket & The David Lloyd Leisure Centre with its range of facilities including indoor and outdoor swimming pools, tennis courts and there is also an onsite creche. Excellent road links are provided, with the A10 being within immediate proximity which links up with the M25 and A406 offering easy access to and around central London.

'Ofsted Outstanding' schools are within walking distance with; Enfield Heights Academy & Ark John Keats Academy to name a few.



Area Map



Floor Plans

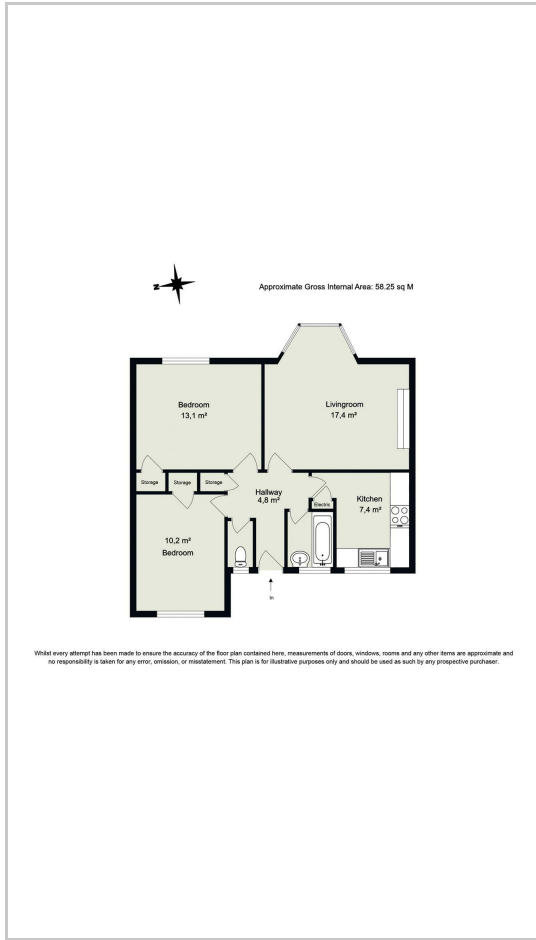

Energy Efficiency Graph

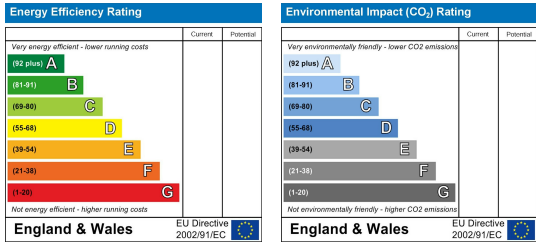

These particulars, whilst believed to be accurate are set out as a general outline only for guidance and do not constitute any part of an offer or contract. Intending purchasers should not rely on them as statements of representation of fact, but must satisfy themselves by inspection or otherwise as to their accuracy. No person in this firm's employment has the authority to make or give any representation or warranty in respect of the property.